

## Technical data sheet

# Type X2900

## 2-piece ball valve

Handle with locking system

### Applications and special features



- Casing and ball in stainless steel 316
- PTFE seal
- Full bore
- Female/female connection
- ISO 5211 top connection
- Handle with locking system.

### Technical description

DN		PFA bar	PS - bar				Cat	References	Vvs-nr
"	mm		L1	L2	G1	G2			
1/2	15	100	100	100	100	100	3.3	149B12103	
3/4	20	100	100	100	100	100	3.3	149B12104	
1	25	100	100	100	100	100	3.3	149B12105	
1 <sup>1/4</sup>	32	100	62	100	x	100	3.3	149B12106	
1 <sup>1/2</sup>	40	100	50	100	x	25	3.3	149B12107	
2	50	100	40	100	x	20	3.3	149B12108	

#### Important notice :

The indicated pressure for the different categories of fluids (L1/L2/G1/G2) is under no condition a guarantee of use. Therefore, it is essential to validate the use of products under given operating conditions.

• **Connection** : Female/female, BSP threaded.

• **Permissible operating pressure PFA - water-** (for supply, distribution and disposal of water) : 100 bar

• **Maximum permissible pressure PS - other mediums** : see table

• **θ** : Mini. -20°C  
Maxi. +100°C -  
See pressure/temperature diagram on page 2

• **Mediums** : Liquids, viscosity up to 120 mm<sup>2</sup>/s

### Overall dimensions

DN	A	B	C	D	øE	
"	mm	mm	mm	mm	mm	
1/2	15	60	74	18	139	35
3/4	20	70	82	21	139	42
1	25	90	96	26	165	52
1 <sup>1/4</sup>	32	110	100	32	165	64
1 <sup>1/2</sup>	40	120	127	38	215	76
2	50	140	134	48	215	96

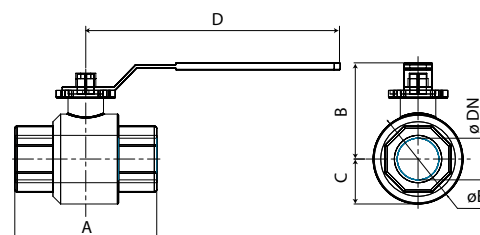

## Technical data sheet    Type X2900 - Ball valves - handle with locking system

### Spare parts list and materials

Description	Materials	EURO	ANSI
CASING	Stainless steel	AISI 316	1.4408
BALL	Stainless steel	AISI 316	1.4401
SHAFT	Stainless steel	AISI 316	1.4401
BALL SEAL	PTFE		
SHAFT SEAL	PTFE+FKM		
HANDLE	Stainless steel		

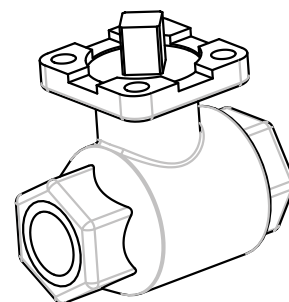

### Working principle

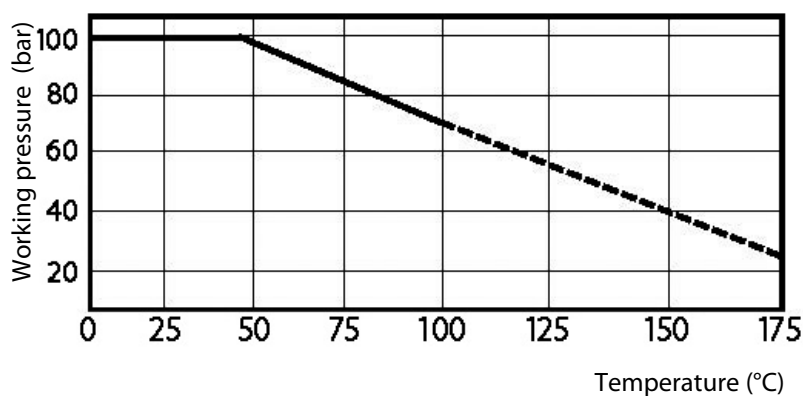

----- Please consult us

Socla can accept no responsibility for possible errors in catalogue, brochures and other printed material. Socla reserve the right to alter its products without notice. This also applies to products already agreed. All trademarks in this material are the property of the respective companies. All right reserved.

### Socla SAS

365 rue du lieutenant Putier  
71530 VIREY LE GRAND  
Postal address : BP 10273  
71107 CHALON SUR SAONE Cedex

Tel : 33 3 85 97 42 52  
Fax : 33 3 85 97 97 42  
<http://www.socla.com>  
e-mail: [commerfr@socla.com](mailto:commerfr@socla.com)